

- NOTES:
1. BLACK "TURTLE TILE" DECKING SHALL BE INSTALLED IN EACH COMPARTMENT
 2. THE "TURTLE TILE" DECKING SHALL HAVE A 2" DEEP BLACK TAPERED EDGE BETWEEN THE COMPARTMENT DOOR AND THE FRONT EDGE OF THE DECKING
 3. THE CHASSIS EXHAUST SYSTEM SHALL BE EXTENDED TO THE RIGHT SIDE OF THE VEHICLE
 4. STAINLESS STEEL HIGH HATS AND LUG NUT COVERS SHALL BE INSTALLED ON CHASSIS WHEELS
 5. (1) PAIR OF ON-SPOT TIRE CHAINS WITH CONTROLS MOUNTED IN THE CAB DASH SHALL BE INSTALLED ON THE APPARATUS

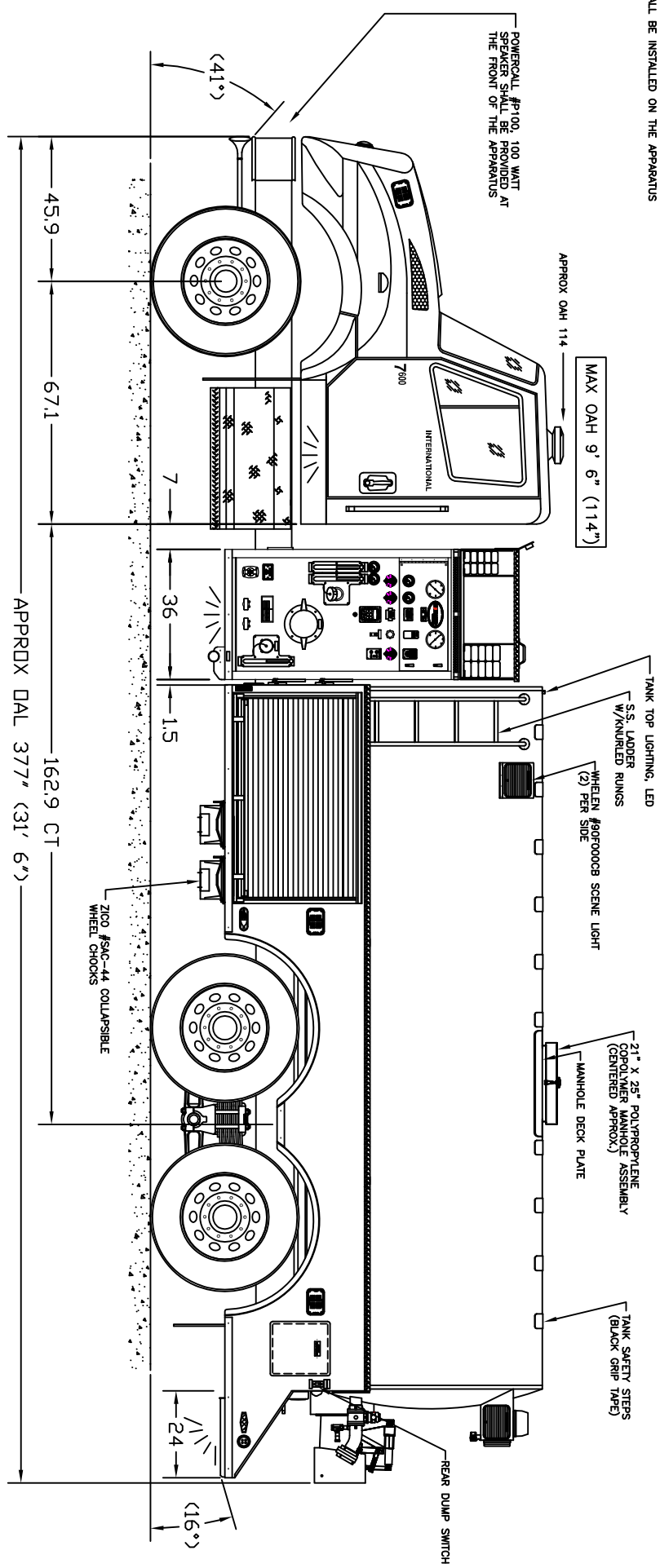

NOTE: PUMP PANEL LAYOUT SHOWN IS FOR REFERENCE ONLY

COMPARTMENTATION			
STREET/CURB - FRONT	INSIDE DIMENSIONS	WIDTH	HEIGHT
		60"	37.5"
			DEPTH
			27"

CUSTOMER APPROVAL

THIS DRAWING IS ONLY A REPRESENTATION OF THE PRODUCT. EXACT LOCATION OF COMPONENTS MAY DIFFER DUE TO MANUFACTURING'S SUPERSEDE PRINTS CHANGE. WRITTEN SPECIFICATIONS SUPERSEDE PRINTS

SIGNATURE _____

TITLE _____

DATE _____

CONCEPT ORDER

BID UST#XXXX

CUSTOMER	DERRY TWP., V.F.D.
SIZE	3000 GALLON
TANK MATERIAL	POLYPROPYLENE COPOLYMER
BODY MATERIAL	STAINLESS STEEL
GROSS SECTION	61" X 83" X 192" LG
AFTERFRAME	72"
PUMP	HALE MFB 750 GPM (PTO)
CHASSIS	INTERNATIONAL 7600 SERIES
DRAWN BY	JLB DATE 4/14/11

USTAKER
TIRE APPARATUS

1827 HOBBS DR.
DELAVAL, WI. 53115
PHONE: 1-(800)-279-4911
FAX: 1-(262)-725-7000
E-MAIL SALES@USTANKER.COM
WEBSITE: WWW.USTANKER.COM

SCALE: 1/30

SHEET: 1 OF 3

REV#: 4/28/11

ALL DIMENSIONS ARE FOR REFERENCE ONLY